

Pressure Vessel 7, 11, 25, 48 & 105 Litre

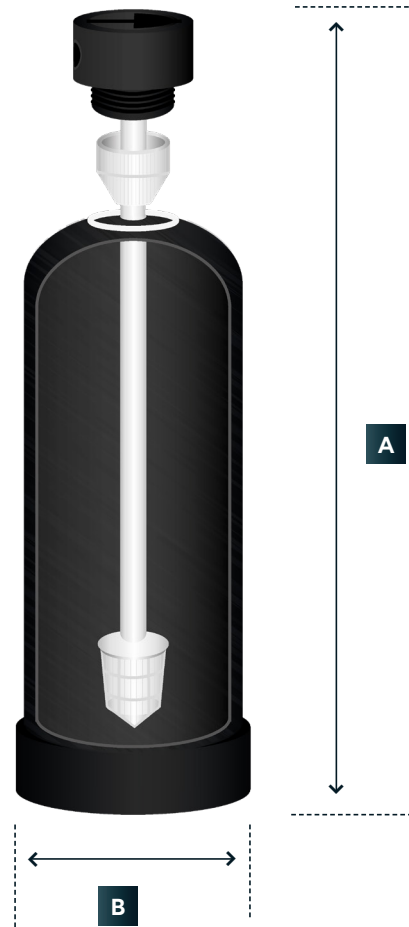

Operating Specification

Operating Temperature - °C (°F)	> 1 (> 49)
Operating Pressure - psi (bar)	150 (10)
Vacuum - mm	> 5
Exposed Temperature - °C (°F)	< 60 (< 140)
Vessel Head Ports - " FBSP	2.5

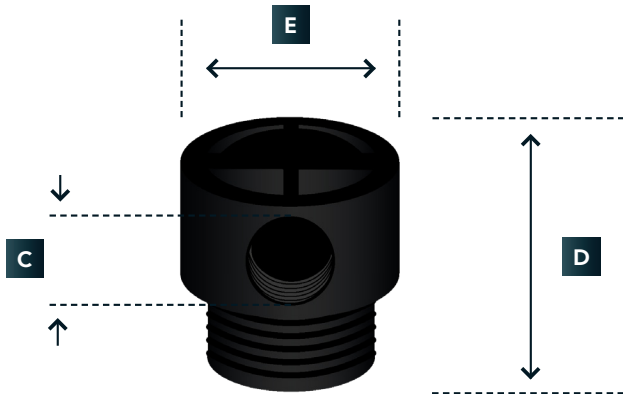

Dimensions

Model	A (mm)	B (mm)	C (mm)	D (mm)	E (mm)
SPF-618	579	150	40	143	80
SPF-817	582	200	40	143	80
SPF-835	835	200	40	143	80
SPF-1044	1044	250	40	143	80
SPF-1354	1354	326	40	143	80



Materials of Construction

Vessel	Fibreglass
Neck Insert Thread	Polypropylene
Vessel Liner	Polypropylene
Head	Polypropylene
Riser Pipe	Polypropylene
O-Ring	EPDM